

# TOGGLE-LOCK™

GRAVITY OUTLET GATE for COVERED HOPPER CARS

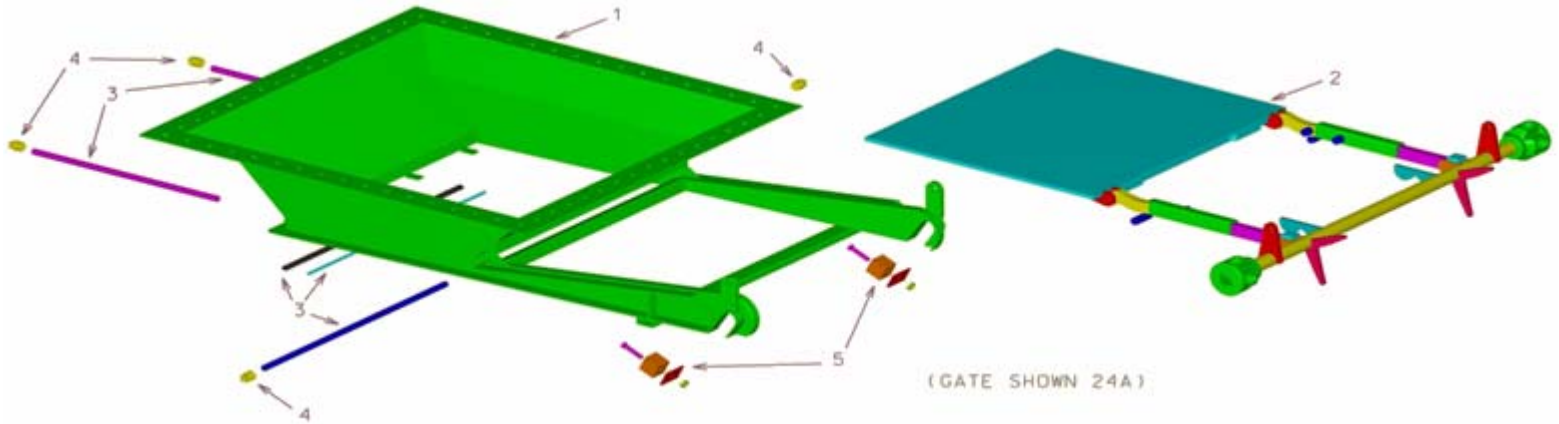

		24A Gate	24D Gate	24W Gate	04A Gate	04E Gate	04H Gate	
<b>Product:</b>		30 X 30	30 X 30	24 X 30	13 X 42	13 X 42	13 X 24	
<b>Working Points:</b>		45 3/8 X 43 3/8	45 3/8 X 43 3/8	37 3/16 X 35 1/8	27 1/8 X 62 3/4	27 1/8 X 62 3/4	20 1/4 X 28 1/4	
<b>Application:</b>		Bolt-On, 66 Hole	Weld-On	Weld-On	Bolt-On, 32 Hole	Bolt-On, 64 Hole	Bolt-On, 24 Hole	
<b>Slope:</b>		Flanged	50°T x 45°L	45°T x 45°L	Flanged	Flanged	45°T x 45°L	
<b>Weight:</b>		432 Lbs.	420 Lbs.	378 Lbs.	472 Lbs.	472 Lbs.	264 Lbs.	
<b>Plate Size:</b>		34 7/8 x 31	34 7/8 x 31	34 7/8 x 31	47 3/4 x 18 3/4	47 3/4 x 18 3/4	26 3/8 x 18 3/4	
<b>Item:</b>	<b>Description:</b>	<b>Qty:</b>						
1	Frame	1	FR24A	FR24D	FR24W	FR04A	FR04E	FR04H
2	Slide Plate, Arms, Shaft Ass'y	1	GS24	GS24	GS24	GS04A	GS04A	GS04
3	Seal Kit	1	TL724	TL724	TL724	TL748	TL748	TL718
4	Seal Pipe Plug	4	12-0100	12-0100	12-0100	12-0100	12-0100	12-0100
5	Bearing Block Ass'y	2	12-0200	12-0200	12-0200	12-0200	12-0200	12-0200

		01H Gate	01W Gate	04W Gate	24F Gate	04M Gate	01M Gate	
<b>Product:</b>		28 X 36	28 X 36	13 X 24	30 X 30	13 X 24	28 X 36	
<b>Working Points:</b>		28 X 36	28 X 36	20 1/4 X 28 1/4	37 3/16 X 35 1/8	20 1/4 X 28 1/4	28 X 36	
<b>Application:</b>		Bolt-On, 32 Hole	Weld-On	Weld-On	Weld-On	Weld-On	Weld-On	
<b>Slope:</b>		45°T x 45°L	45°T x 45°L	45°T x 45°L	50°T x 50°L	45°T x 45°L	45°T x 45°L	
<b>Weight:</b>		365 Lbs.	365 Lbs.	264 Lbs.	378 Lbs.	268 Lbs.	374 Lbs.	
<b>Plate Size:</b>		35 3/4 x 24 1/4	35 3/4 x 24 1/4	26 3/8 x 18 3/4	34 7/8 x 31	26 3/8 x 18 3/4	35 3/4 x 24 1/4	
<b>Item:</b>	<b>Description:</b>	<b>Qty:</b>						
1	Frame	1	FR01H	FR01W	FR04W	FR24F	FR04M	FR01M
2	Slide Plate, Arms, Shaft Ass'y	1	GS01	GS01	GS04	GS24	GS04	GS01
3	Seal Kit	1	TL723	TL723	TL718	TL724	TL718	TL723
4	Seal Pipe Plug	4	12-0100	12-0100	12-0100	12-0100	12-0100	12-0100
5	Bearing Block Ass'y	2	12-0200	12-0200	12-0200	12-0200	12-0200	12-0200